

# DIGITAL RADIO CONTROLS

## INSTALLATION INSTRUCTIONS



### WARNING:

- Disconnect power before any installation or repair.
- Wear safety glasses.

### WARRANTY

Your Linear Multi-Code™ digital radio controls are warranted to the original purchaser against defects in material or workmanship for a period of eighteen (18) months from the date of purchase. This warranty will be considered void if damage is due to improper installation, improper use, connection to improper power source, or if damage is due to fire or lightning. Replacement of batteries is not covered by warranty.

### RECEIVER INSTALLATION - MODEL 3090

Mount the receiver directly on the operator by sliding the receiver tabs underneath the three terminal screws located on the operator. (See diagram below.) Remember to reconnect your wall button wires.

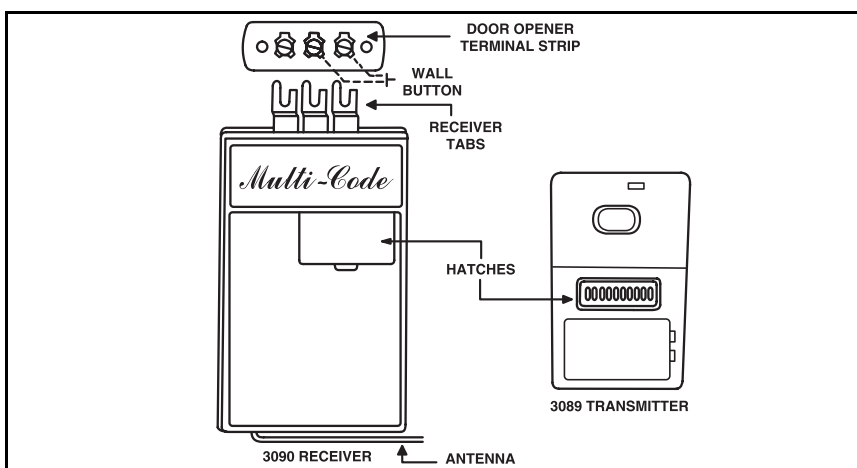

### TRANSMITTER - MODEL 3089

The transmitter is self-contained, including battery. It can be operated while being held in your hand, or while mounted in your car. A clip is supplied so that the transmitter may be mounted on your sun visor. When using the clip, slide it under the two straps on the back of the transmitter until the small knob fits into the hole in the clip.

**CAUTION:** *Keep the clip flat when pushing it into position so that it doesn't extend down into the case and cause damage.*

### TRANSMITTER BATTERY REPLACEMENT

Replacement battery - 9 volt carbon zinc (non-alkaline). The battery can be checked or changed by popping open the front lower half of the transmitter using a slot screwdriver. Replace used battery and re-assemble the transmitter case.

### SELECTING A CODE

Use a slot screwdriver to pop open the front lower half of the transmitter and the receiver door for access to the code switches. Set both sets of switches to the code of your choice. Be sure both are set to the exact same code, since a different setting of just one switch will prevent operation. Once the code has been set, check the operation, and replace the hatches.

### OPERATIONAL CHECK

To check operation, move back a reasonable distance (30-50 feet), press and hold the transmitter button for two seconds. If operation is unsatisfactory, the problem may be isolated by:

1. Checking the door operator. If the door will not open when the wall button is pressed, the problem is likely to be the operator. When the door opens by pressing the wall button, but not the transmitter, then the problem is likely with the radio controls.
2. Reposition the antenna, and try it again.
3. Replace the transmitter battery.

Changes or Modifications not expressly approved by Linear Corporation could void the user's authority to operate the equipment.

When controls do not function after performing the above tests, they should be returned to your dealer for repair or replacement. They may also be returned, postage prepaid, directly to:

**LINEAR CORPORATION**  
2055 CORTE DEL NOGAL, CARLSBAD, CA 92009